

Battery Replacement

1. Insert your SentiCard® and enter PIN+ENT.
2. Remove your SentiCard® and open the lockbox to access the Battery cover.
3. Remove both Phillips screws that hold the battery cover (show on the illustration).
4. Replace both CR123A batteries following the polarity symbols correctly.

WARNING: Inserting batteries with wrong polarity will permanently damage lockbox! Do not allow the lockbox to close with the batteries removed.

5. Place battery cover and tighten the screws.



Open lockbox

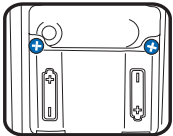

Remove screws and replace both batteries

LockBox Commands Quick Overview

- Release Shackle from your lockbox:
FUNC + 1 + ENT
- Release Shackle from a lockbox you don't own:
FUNC + 1 + Shackle Code + ENT
- Set Lockbox Location:
FUNC + 2 + MLS Number + ENT or
FUNC + 2 + Address Number + ENT
- Open Key Compartment:
FUNC + 3 + ENT
- Turn **ON** Contractor Mode:
FUNC + 6 + 1 + ENT
- Turn **OFF** Contractor Mode:
FUNC + 6 + 0 + ENT
- Turn **ON** CBS Mode:
FUNC + 6 + 9 + ENT
- Turn **OFF** CBS Mode:
FUNC + 6 + 8 + ENT
- Download Audit / Access Log from a lockbox:
FUNC + 7 + ENT
- Lock the Keypad:
FUNC + 6 + 7 + ENT

How to Get Help...

SentriLock provides technical support services 7 days a week to all REALTOR® Lockbox customers.

- Phone: **1-877-736-8745**
8:00AM-5:00PM your local time
- Send details via e-mail:
support@sentrilock.com
- On the Web:
http://lockbox.sentrilock.com/
click on "Support" button
- SentiLock Card Utility:
Click on "Help" menu item
and select "Support..."



www.sentrilock.com • 877-736-8745

© 2009 SentriLock, LLC

Pocket Reference Guide



REALTOR® Lockbox NXT

IMPORTANT: You will need your SentiCard® and Personal Identification Number (PIN) to perform the following operations

Opening the Key Compartment

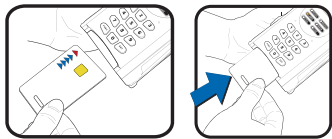

1. Insert SentiCard gold chip contact up.

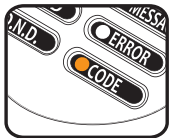

2. Wait for CODE light.



3. PIN(****) + ENT.



4. Remove card.



5. Open key bin.

Removing Shackle



1. Insert SentiCard®.

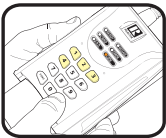

2. PIN + ENT.

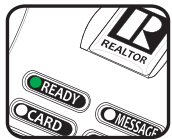

3. Wait for READY light.



4. FUNC + 1 + ENT.

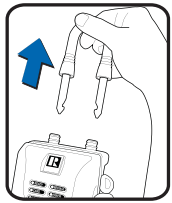

5. Remove shackle.



6. Wait for READY light before re-inserting shackle.

Placing your Lockbox on a Listing

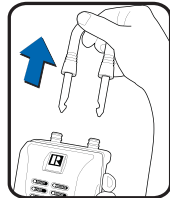

1. Remove shackle.



2. Leave your SentiCard® inserted.



3. FUNC+2 followed by MLS or address #.



4. Press ENT when complete.

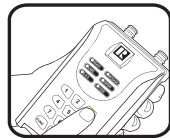

5. FUNC + 3 + ENT.



6. Open Key Bin.

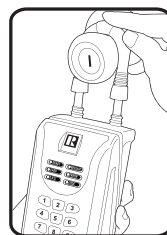

7. Hang lockbox from secure spot in a vertical orientation.



8. Press the shackle into the lockbox.

Renew Card at Lockbox



1. Call 877-736-8745 option # 2.



2. Insert Card.



3. FUNC 0 + renewal code + ENT.



4. Remove & re-insert card. Use normally.